

NHRC

Straight

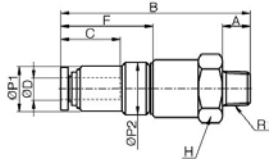

MODEL [ØD-T]

Tube (Metric) - Thread(R)

| MODEL | ØD | R |
|------------|----|------|
| NHRC 04-M5 | 4 | M5 |
| NHRC 04-M6 | 4 | M6 |
| NHRC 04-01 | 4 | R1/8 |
| NHRC 06-01 | 6 | R1/8 |
| NHRC 06-02 | 6 | R1/4 |
| NHRC 08-01 | 8 | R1/8 |
| NHRC 08-02 | 8 | R1/4 |
| NHRC 10-03 | 10 | R3/8 |
| NHRC 10-04 | 10 | R1/2 |
| NHRC 12-03 | 10 | R3/8 |
| NHRC 12-04 | 12 | R1/2 |

NHRC-G

Straight

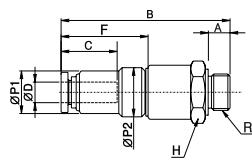

MODEL [ØD-T]

Tube (Metric) - Thread(G)

| MODEL | ØD | R |
|-------------|----|------|
| NHRC 04-G01 | 4 | G1/8 |
| NHRC 06-G01 | 6 | G1/8 |
| NHRC 06-G02 | 6 | G1/4 |
| NHRC 08-G01 | 8 | G1/8 |
| NHRC 08-G02 | 8 | G1/4 |
| NHRC 08-G03 | 8 | G3/8 |
| NHRC 10-G03 | 8 | G3/8 |
| NHRC 10-G04 | 10 | G1/2 |
| NHRC 12-G03 | 12 | G3/8 |
| NHRC 12-G04 | 12 | G1/2 |

NHRL

Elbow

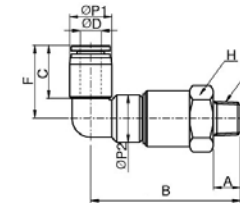

MODEL [ØD-T]

Tube (Metric) - Thread(R)

| MODEL | ØD | R |
|------------|----|------|
| NHRL 04-M5 | 4 | M5 |
| NHRL 04-M6 | 4 | M6 |
| NHRL 04-01 | 4 | R1/8 |
| NHRL 06-01 | 6 | R1/8 |
| NHRL 06-02 | 6 | R1/4 |
| NHRL 08-01 | 8 | R1/8 |
| NHRL 08-02 | 8 | R1/4 |
| NHRL 10-03 | 10 | R3/8 |
| NHRL 10-04 | 10 | R1/2 |
| NHRL 12-03 | 10 | R3/8 |
| NHRL 12-04 | 12 | R1/2 |

NHRL-G

Elbow

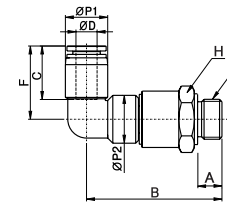

MODEL [ØD-T]

Tube (Metric) - Thread(G)

| MODEL | ØD | R |
|-------------|----|------|
| NHRL 04-G01 | 4 | G1/8 |
| NHRL 06-G01 | 6 | G1/8 |
| NHRL 06-G02 | 6 | G1/4 |
| NHRL 08-G01 | 8 | G1/8 |
| NHRL 08-G02 | 8 | G1/4 |
| NHRL 10-G03 | 10 | G3/8 |
| NHRL 10-G04 | 10 | G1/2 |
| NHRL 12-G03 | 12 | G3/8 |
| NHRL 12-G04 | 12 | G1/2 |